

CONCRETE THRUST BLOCK SEE S-18B FOR DIMENSIONS A,B,C,D.

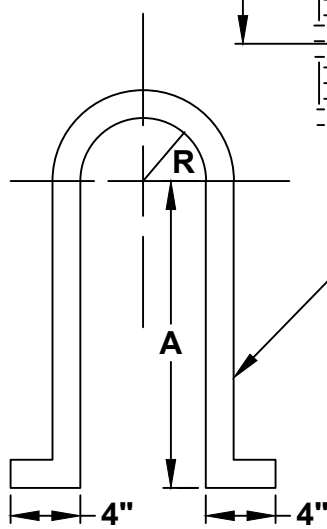

STRAP DETAIL

SIZE	A	R	LENGTH OF STEEL STRAP
6"	1' - 11 1/2"	3 1/2"	5' - 4 1/2"
8"	1' - 11 7/8"	4 21/32"	5' - 10 1/4"
10"	2' - 1"	5 45/64"	6' - 4"
12"	2' - 2"	6 3/4"	6' - 9 3/4"
14"	2' - 3 3/8"	7 21/16"	7' - 3"
16"	2' - 4 3/4"	8 3/4"	7' - 8 1/2"
20"	2' - 6"	10 3/4"	8' - 8"
24"	2' - 9 1/2"	12 7/8"	9' - 7 1/2"



CITY OF CUMMING

DEPARTMENT OF UTILITIES

THRUST RESTRAINT UPWARD THRUST

DETAIL NUMBER:

S-18A

SCALE: NOT TO SCALE

LATEST REVISION

07/14/2017