

FIRE HYDRANTS TO BE PLACED SO THAT THEY FACE THE STREET (LARGE HOSE CONNECTOR FACES THE STREET)

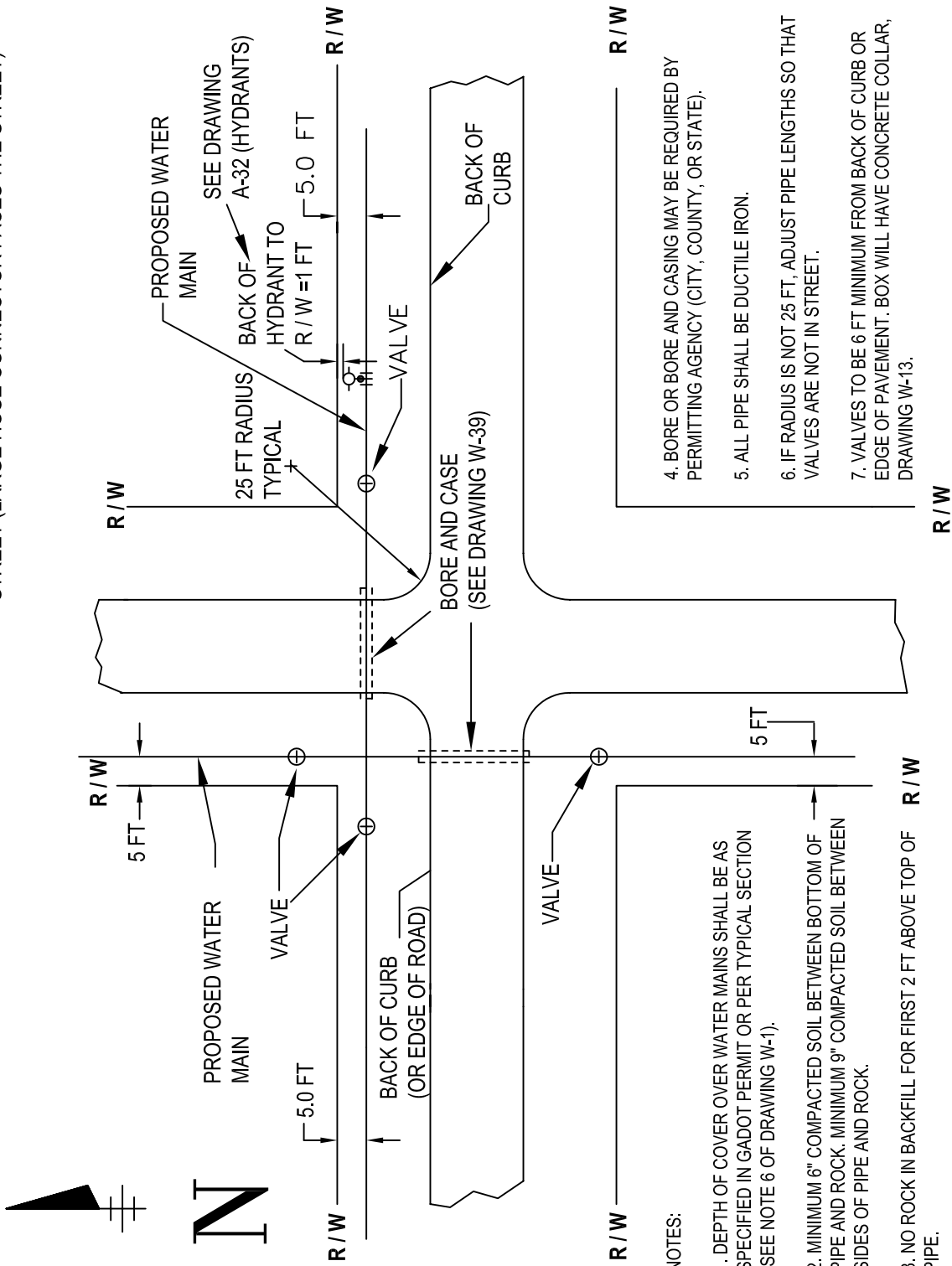

NOTES:

1. DEPTH OF COVER OVER WATER MAINS SHALL BE AS SPECIFIED IN GADOT PERMIT OR PER TYPICAL SECTION (SEE NOTE 6 OF DRAWING W-1).
2. MINIMUM 6" COMPACTED SOIL BETWEEN BOTTOM OF PIPE AND ROCK. MINIMUM 9" COMPACTED SOIL BETWEEN SIDES OF PIPE AND ROCK.
3. NO ROCK IN BACKFILL FOR FIRST 2 FT ABOVE TOP OF PIPE.
4. BORE OR BORE AND CASING MAY BE REQUIRED BY PERMITTING AGENCY (CITY, COUNTY, OR STATE).
5. ALL PIPE SHALL BE DUCTILE IRON.
6. IF RADIUS IS NOT 25 FT, ADJUST PIPE LENGTHS SO THAT VALVES ARE NOT IN STREET.
7. VALVES TO BE 6 FT MINIMUM FROM BACK OF CURB OR EDGE OF PAVEMENT. BOX WILL HAVE CONCRETE COLLAR, DRAWING W-13.

REVISIONS

City of Cumming

Department of Utilities - Distribution and Collection Division

INTERSECTIONS DETAILS FOR WATER MAINS, VALVES, AND FIRE HYDRANTS (GADOT & EXISTING COUNTY ROADS)



W-9